

REVOLUTION HANDSET BUTTON EXPLANATION

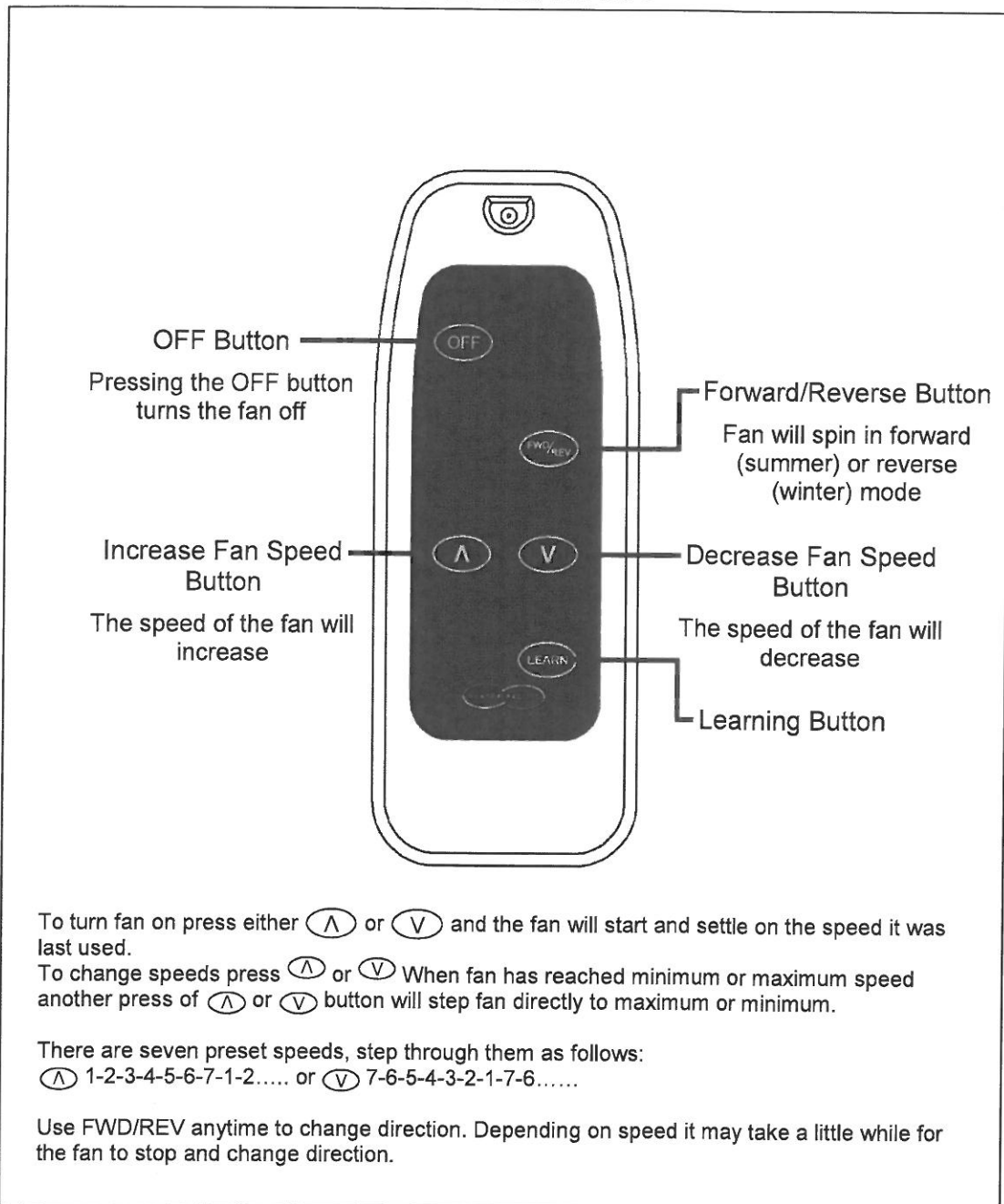

1. **Do not** attempt to operate the fan with any wall control. This fan operates using remote control or optional special modules only. Contact Hunter Pacific International for details. Any modification or attempt to directly wire the fan will void warranty unless those modifications are authorised.



I N T E R N A T I O N A L

Revolution Installation Manual

REVOLUTION CONTROL MODULE AND HANDSET PROGRAMMING

MAKE SURE THE WALL SWITCH IS ON OR REMOTE CONTROL WILL NOT WORK

Handset Battery Installation/Replacement

Open the battery compartment by sliding the hatch downwards. Gently press the grooved section inwards to disengage latch. UNWRAP THE PLASTIC FROM AROUND NEW BATTERIES. Observe polarity and make sure battery sits properly in recess. Slide hatch back into place.

How To Add a New or Replacement Handset

The receiver can learn the identification code for a new handset using the following procedure:

- A. Turn off the MAINS POWER to the Control Module for 30 seconds
- B. Toggle the MAINS POWER ON and OFF as follows (each ON and OFF must be 2 secs).

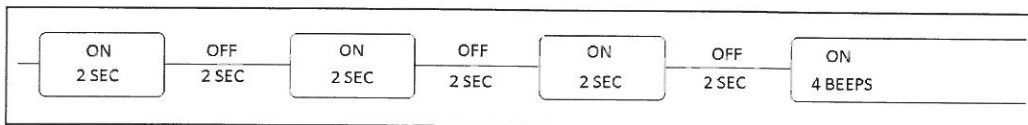

- C. The Control Module will beep four times when it enters program mode. The duration of each on period and each off period must be 2 seconds. Depending on how accurate the 2 second periods are the Control Module should enter program mode after 3 or 4 cycles of turning the power on/off. If the 2 second periods are too short or too long simply keep toggling power until it does enter program mode.

IMPORTANT: IF MULTIPLE FANS ARE CONNECTED TO THE SAME FINAL CIRCUIT OR FED FROM THE SAME POWER SWITCH THEN PROGRAM THE CONTROL MODULE BY PLUGGING IT INTO A GPO/POWER POINT BEFORE INSTALLATION.

NOTE: THE MAINS POWER TO THE CONTROL MODULE MUST BE SWITCHED ON-OFF VIA AN EXTERNAL SWITCH. **NOT** THE BUTTONS ON THE HANDSET.

- D. Move the new handset to within 2 metres of the receiver and press "LEARN" button on the handset to add it, or the OFF button to erase all handsets from control module memory (without any handsets the module will beep 4 times when powered)

SEE TERMS AND CONDITIONS OF WARRANTY. YOU WILL BE CHARGED A SERVICE FEE IF THE PRODUCT IS NOT DEFECTIVE OR IS DAMAGED BY POWER SURGES, LIGHTNING, WEATHER, MISUSE/ABUSE AND SIMILAR SITUATIONS. ALL INSTALLATION INSTRUCTIONS MUST BE FOLLOWED.



1. **Do not** attempt to operate the fan with any wall control. This fan operates using remote control or optional special modules only. Contact Hunter Pacific International for details. Any modification or attempt to directly wire the fan will void warranty unless those modifications are authorised.