



Majestic Coolah 52"

- 3 SPEED PULL CORD
- REMOTE ADAPTABLE
- REVERSIBLE
- 11° BLADE PITCH
- 7 YEAR WARRANTY



830
WHITE
With white blades
(Rattan Insert on one side)
1320mm (52")



837
ANTIQUE BRASS
With walnut blades
(Rattan Insert on one side)
1320mm (52")

^Please refer to website terms & conditions

Majestic Coolah 52"

Product Range:

- 830 - White with White Blades
- 837 - Antique Brass with Walnut Blades

Features:

- 3 Speed pull cord
- Summer/Winter reversible via switch on motor
- Plywood blades
- Remote adaptable
- 3 speed wall control adaptable
- Suitable for flat & pitched ceilings up to 32°
- 7 Year warranty.

Installation Locations:

Indoor installation only.

Warranty:

- 3 year in-home warranty on the motor, excluding cosmetic issues and corrosion (unless reported in the first 3 months).
- 4 year additional Parts Only Warranty on the motor.
- All non-integrated HPI light kits and AC remote control systems are separately purchased accessories for AC ceiling fans, and as such are covered by our accessory parts warranty.
- 1 year warranty applies when the fan or relevant part is used in any non-domestic applications.

*For full warranty details please see Hunter Pacific International's website www.hunterpacific.com.au

Accessories (Supplied separately):

Down Rod 21mm diameter (includes wire harness)

- 050 - 91cm White Downrod
- 060 - 180cm White Downrod
- 067 - 180cm Antique/Brass Downrod

009 - T-Hook for ceiling roses

AC Remote Control Units

- A2002 - Konetik (3 speed - non dimming AC remote)
- A2003 - Logic (4 speed - dimming AC remote)

Zellweger Ripple Tone Filter Unit

- 007 ZF-1050 Notch Filter Noise Suppressor
- 008 ZF-750 Notch Filter Noise Suppressor
- W06-026 Wall Mech & Capacitor 2 & 3.5uF
- A3480 Eclipse White 2 x E27

Extra Information:

Motor: 153mm x 15mm motor 16 Pole
Made with the highest grade copper windings and silicone steel stator. Bearings are sealed to ensure quiet operation and long life.

Blades: 1320mm (52")
Materials: NZ Plywood (Flat colours- Painted & Lacquered, Wood grain colours - Laminated & Lacquered)
Blade Pitch: 11°

Weight Including Packaging:

Complete fan: 6 kg

Packaging Dimensions (cm):

Complete fan: 53L x 25W x 26H

	Low	Medium	High
RPMS	101	136	197
WATTS	18.5	31.0	60.9
AIRFLOW: CMH*	5168	7189	11073

* CMH = Cubic Meters per Hour

DIMENSIONS

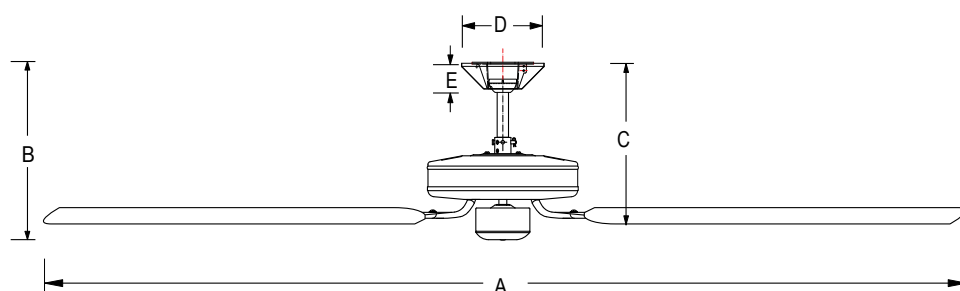

A	1320mm
B	360mm
C	310mm
D	173mm
E	53mm