



# Azure Moulded 48"

- 3 SPEED WALL CONTROL
- REMOTE ADAPTABLE
- REVERSIBLE
- 10° BLADE PITCH
- 7 YEAR WARRANTY



A223  
**WHITE**  
With white moulded blades  
1220mm (48")

^Please refer to website terms & conditions

# Azure Moulded 48"

## Product Range:

A223 - White with White Blades

## Features:

- 3 Speed wall controller
- Summer/Winter reversible via switch on motor
- Moulded plastic blades
- Remote Adaptable
- Suitable for flat & pitched ceilings up to 28°
- 7 Year warranty

## Installation Locations:

Indoor installation only.

There should be at least 2.1m between the lowest point of the fan blades and the floor.

## Wall Controller Speed Capacitor Values:

3.5µF & 2µF

## Warranty:

- 3 year in-home warranty on the motor, excluding cosmetic issues and corrosion (unless reported in the first 3 months).
- 4 year additional Parts Only Warranty on the motor.
- All non-integrated HPI light kits and AC remote control systems are separately purchased accessories for AC ceiling fans, and as such are covered by our accessory parts warranty.
- 1 year warranty applies when the fan or relevant part is used in any non-domestic applications.

\*For full warranty details please see Hunter Pacific International's website [www.hunterpacific.com.au](http://www.hunterpacific.com.au)

## Accessories (Supplied separately):

### Down Rod 21mm diameter (includes wire loom)

- 050 - 91cm White Downrod
- 060 - 180cm White Downrod

009 - T-Hook for ceiling roses

### AC Remote Control Units

- A2002 - Konetik (3 speed - non dimming AC remote)
- A2003 - Logic (4 speed - dimming AC remote)

### Zellweger Ripple Tone Filter Unit

- 007 - ZF-1050 Notch Filter Noise Suppressor
- 008 - ZF-750 Notch Filter Noise Suppressor

- W06-015 Capacitor 2 & 3.5µF
- W06-018 Wall Mech & Knob Only
- W06-023 Start Run Cap 1.8µF
- W06-026 Wall Mech & Capacitor 2 & 3.5µF

## Extra Information:

**Motor:** 153mm x 15mm motor 16 Pole, Made with the highest grade copper windings and silicone steel stator. Bearings are sealed to ensure quiet operation and long life.

**Blades:** 1220mm (48") Straight Style  
Materials: Moulded plastic  
Blade Pitch: 10°

## Weight Including Packaging:

Complete fan: 7.9kg

## Packaging Dimensions (cm):

54.3L x 25.3W x 27.5H

	Low	Medium	High
RPMS	102	145	182
WATTS	16.9	36.3	64.0
AIRFLOW: CMH*	6459	8637	11542

\* CMH = Cubic Meters per Hour

## DIMENSIONS

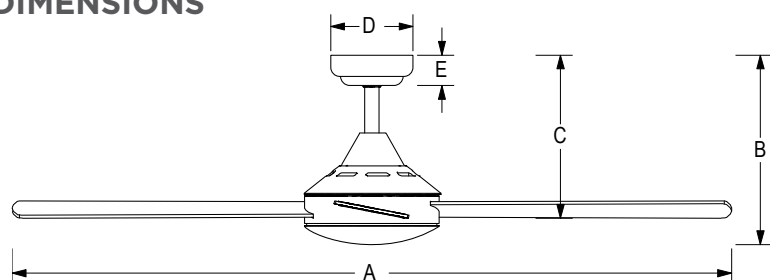

A	1220mm
B	363mm
C	316mm
D	131mm
E	57mm